

**Clark College
Firstenburg Dental Hygiene
Education and Care Center**



**Exam Site Information
CDCA-WREB-CITA
2023 Local Anesthesia & Restorative Examinations**

**Clark College
Health Science Center Main Campus
1933 Fort Vancouver Way
Vancouver, WA 98663
360-992-2127
Physical building address: 2232 E. Reserve Street, Vancouver, WA 98661**

Exam Site Information for Candidates
2023 CDCA-WREB-CITA Local Anesthesia & Restorative Examinations

Table of Contents

1. School Facility and Services

- Facility Fees
- Clinic Address, Building Access and Hours
- Parking
- Security and Emergency Services
- ATM Machine
- Food Services Onsite

2. Preparing for the Exam

- Patient Screening
- Dental Operatory Units
- Equipment, Instruments and Expendable Materials
- Sterilization Services

3. During the Exam

- Infection Control (Surface Asepsis)
- Medical Emergencies and Equipment

4. Travel and Lodging Information

- Airport Information
- Ground Transportation
- Hotel Accommodation

5. Campus Map

6. Clinic Floor Plan

7. Required School-provided Expendable Dental Materials Appendices

1. School Facility and Services

- **Facility Fees**
 - The facility fee is \$65.00 for Local Anesthesia and \$60.00 for Restorative and will be collected by CDCA-WREB-CITA at time of online registration.
- **Location, Building Access and Hours:** Clark College Dental Hygiene Clinic, Health Science Center: physical building address 2232 E Reserve Street, Vancouver, WA 98661. College contact: Marci Wedemeyer 360-992-2127 Directions to Clinic entrance; the clinic is located in the North East corner of the main college campus, off of East Reserve Street, park in the Brown 1 parking lot. Building open 6:00am-6:00pm daily for duration of exam.
- **Parking:** Candidates and patients can park in any unmarked parking spot during the weekday at no charge. Do not park in Dental Patient Parking or F/S parking, these require permits or passes. There are no parking restrictions on weekends.
- **Security and Emergency Services:** Onsite Security can be contacted 24 hours a day at 360-992-2133, or by dialing 2133 from a clinic phone.
- **ATM Machine:** Available in Gaiser Hall just to the West of the dental clinic.

2. Preparing for the Exams

- **Clark College Clinic Attire:**
 - **Scrubs**
 - **Closed toed puncture resistant shoes**
 - **Knee length long sleeve lab jacket with name/logo covered, disposable gowns will be available**
 - **Eye protection with side shields, OSHA accepted for clinician and patient**
 - **Long socks to cover above the ankle**

Local Anesthesia Exam

A. Equipment, Instruments and Expendable Dental Materials: Refer to the respective Local Anesthesia Candidate Guide for a list of materials and armamentarium that the candidate must provide.

B. Syringe Tips: The use of disposable air/water syringe tips is prohibited at Clark College. Each unit will be supplied with metal air/water syringe tip(s) for exams as needed. The metal tip(s) is the property of Clark College and will be bagged for sterilization at the end of the exam.

C. Expendable Materials: Expendable dental materials supplied by the school are noted in **Appendix A**.

- **Sterilization Services:** The sterilization of instruments, **for retake purposes only**, will be done by the school coordinator or clinic assistant. Instruments will be processed and ready for the candidate prior to their retake exam. Instruments will on the results table when sterilization is complete. Candidate will prepare instruments for sterilization by writing their candidate number only on the provided bag(s), taking the bag(s) and instruments back to the counter at the sterilization room for processing. Please make sure to inform the school coordinator or the

clinic assistant that the instruments are ready for sterilization.

Restorative Exam

- **Equipment, Instruments and Expendable Dental Materials:** Refer to the respective Restorative Candidate Guide for a list of materials and armamentarium that the Candidate must provide. The clinic has a-Dec dental chairs and delivery systems with post mount for the typodont.

- D. Handpiece and Prophy Angle Hookups:** The clinic is equipped with A-Dec chairs, there are two handpiece hoses available on each unit: a six (6) pin A-Dec high speed handpiece hose and a four (4) pin A-Dec slow speed hose. The handpiece(s) must be air driven and not electric. Candidates are responsible to supply their own handpiece, motor and attachment. If a candidate needs a handpiece, latch or prophy angle attachment they will be available for rent with **prior arrangements**. Rental charge for each handpiece is \$25.00 payable by cash or cashier's check, no personal checks or debit/credit cards can be accepted. A deposit check of \$500.00 must be left with the school coordinator, the deposit will be returned when the handpiece is returned. Rental charge for the latch and/or prophy angle will be \$20.00 payable by cash or cashier's check, no personal checks or debit/credit cards can be accepted, with a \$100.00 deposit check to be returned to you when rental item is returned.

- E. Air/Water Syringe Tips:** The use of disposable air/water syringe tips is prohibited at Clark College. Each unit will be supplied with one metal air/water syringe tip for clinical exam. The metal tip(s) is the property of Clark College and will be bagged for sterilization at the end of the exam.

- F. Curing Lights:** Curing lights and shields will be provided at each unit.

- G. Expendable Materials:** Expendable dental materials supplied by the school are noted in **Appendix B**.

4. During the Clinical Exam

- **Dental Operatory Units:** The clinic is equipped with A-Dec chairs and delivery systems, with a variety of ergonomic and traditional operator stools.

- A. Infection Control (Surface Asepsis):** Barriers will be placed on the dental chair, light handles, bracket tray handle, A/W syringe, saliva ejector, and on the handles of the operator stool. At the end of your exam all barriers will be removed and discarded, candidates will use disinfecting wipes to clean all surfaces of the dental chair, dental light, operator stool and unit counter tops. Each candidate will re-barrier the chair for the next candidate.

- B. Hazardous Waste Disposal (exam-type specific):**
 - **Local Anesthesia:** Any blood saturated items will be disposed in a chairside biohazard bag, these bags will be sealed and put into the biohazard box located across from the sterilization room.
 - **Restorative:** Amalgam scraps from the catch bag and amalgam well will be dumped out into the Amalgam scrap jar(s) next to the amalgamator.

- C. Sharps Disposal:** Anesthetic needles and carpules will be disposed of in the chairside sharp's container provided. The cardboard needle protector, if used, can

be disposed of in the chair side trash receptacle, do not put protector cards in sharps container.

- **Emergency Medical Equipment:** All medical emergency equipment is located in the northwest corner of the clinic across from the sterilization room and marked with a ceiling sign.
 - Two (2) portable oxygen tanks available, each equipped with an oxygen mask.
 - Emergency medical supplies and medications are located in the mobile emergency cart
 - AED is located in the mobile emergency cart.
 - In case of emergency:
 - Notify CDCA-WREB-CITA personnel that you need assistance
 - Call EMS by dialing 911 directly
 - Have emergency cart brought to your unit by a CDCA-WREB-CITA representative or School representative

5. Travel and Lodging Information

- **Airport Information:** Portland International Airport (PDX) is located 12.5 miles away from the college, www.flypdx.com/PDX
- **Ground Transportation:** Information available from the PDX website, www.flypdx.com/PDX, regarding ground transportation options.
- **Hotel Accommodations:**
 - Homewood Suites by Hilton: 360-750-1100
 - Hilton Vancouver: 360-993-4500
 - Heathman Lodge: 855-516-1090
 - Holiday Inn Express & Suites Vancouver Mall 1-888-480-0427
 - Comfort Suites Vancouver Mall 360-356-1685

6. Campus Map:

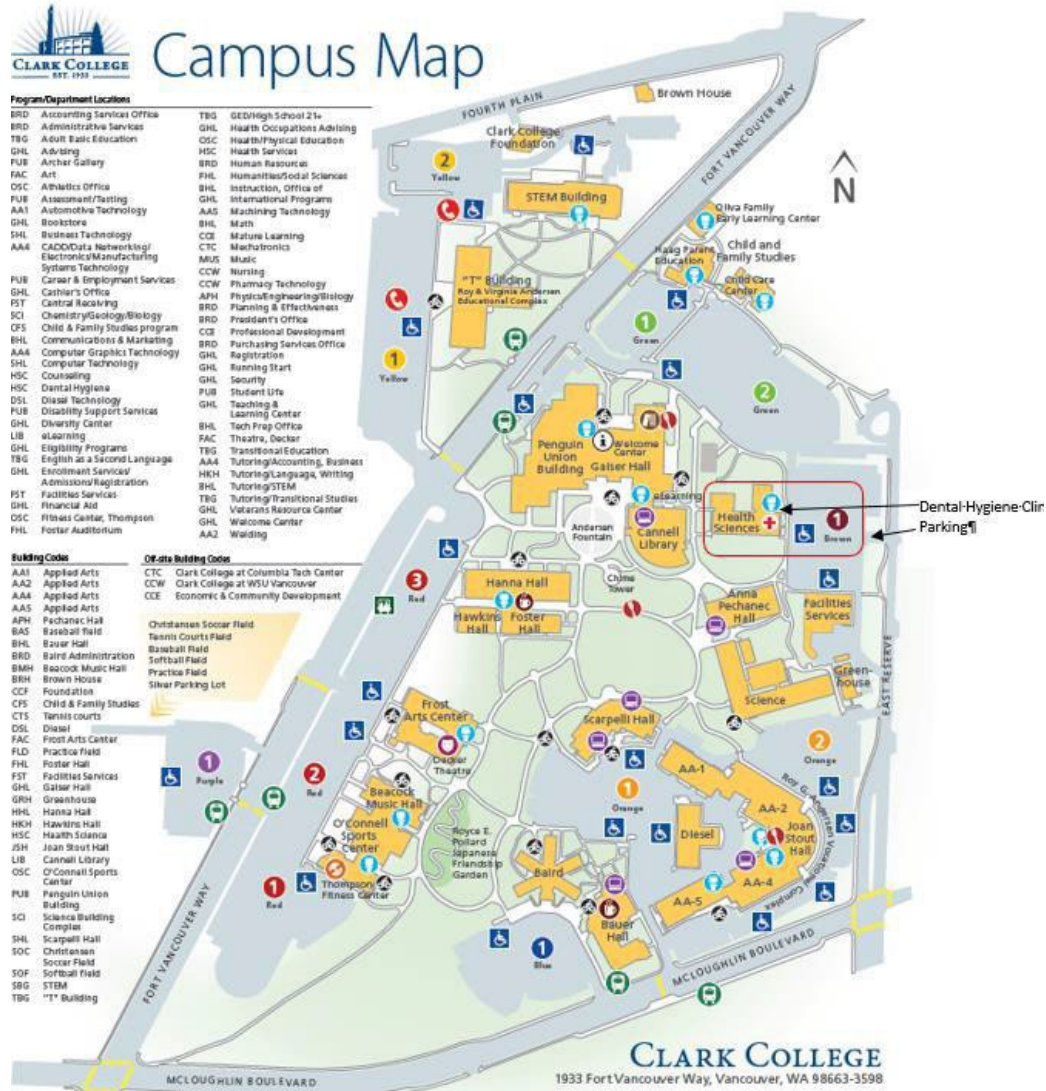

Driving Directions: www.clark.edu/about/visitors-guide/getting-to-clark/maps/google/index.php

Physical building address: 2232 E. Reserve Street, Vancouver, WA 98661

7. **Clinic Floor Plan:** Indicate Patient waiting area, Candidate clinic, Examiner grading area, areas of emergency equipment.

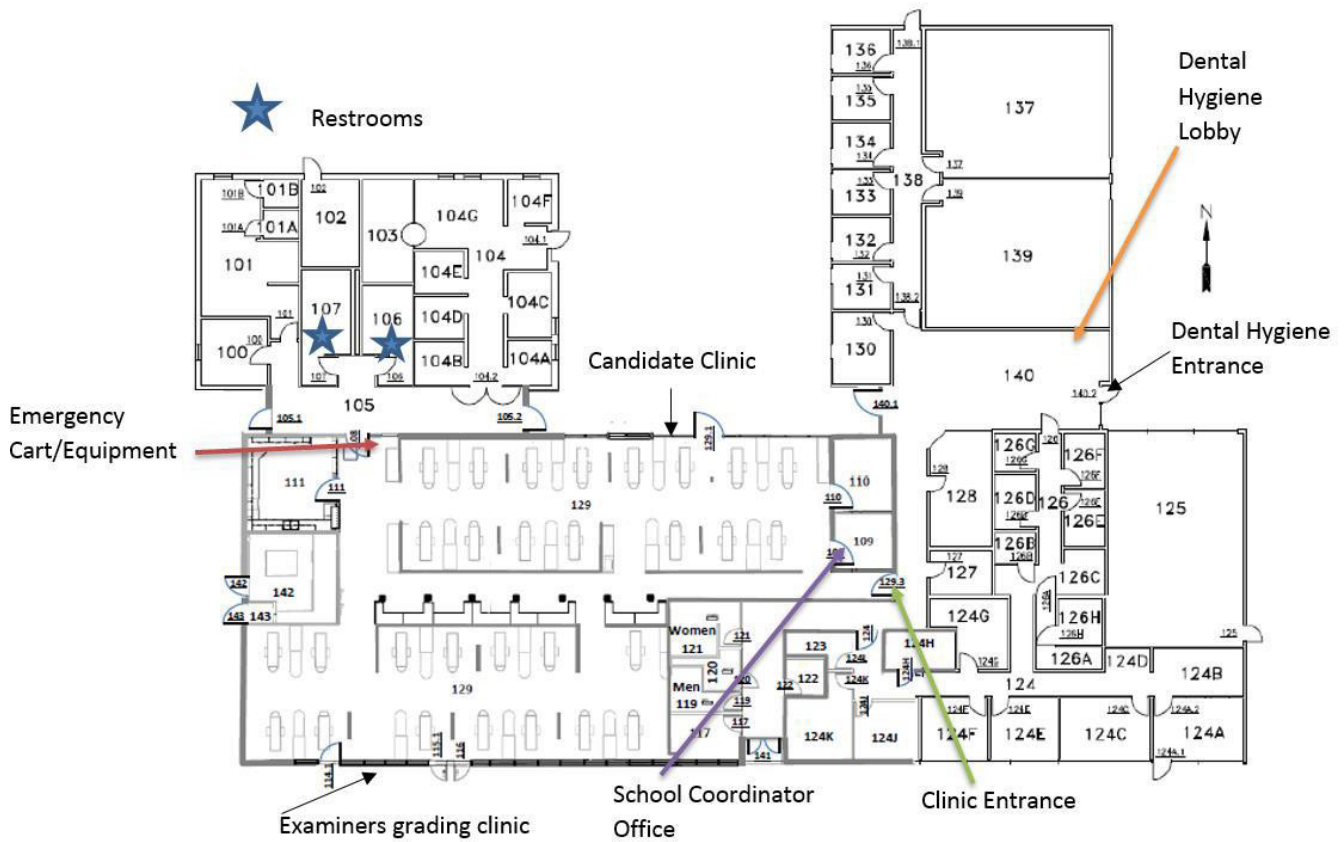

Required School-provided Expendable Dental Materials Appendices

APPENDIX A – Expendable Local Anesthesia Materials List Provided by Exam Site Host (Clark College) To be provided in sufficient quantities for all Local Anesthesia Candidates		
2x2 gauze squares	Cotton-tip applicators	Patient bib clips, disposable
Air/water syringe tips	Drinking cups	Patient napkins/bibs
Antimicrobial mouthwash	Face masks	Sanitizing materials
Anesthetic(s)	Facial tissue	Soap
<ul style="list-style-type: none"> • Local anesthetic(s) • 3% Carbocaine plain • 4% Articaine 1:100,000 • 2% Lidocaine 1:100,000 • 4% Prilocaine 1:200,000 • 0.5% Marcaine 1:200,000 	Gloves	Standard saliva ejectors
<ul style="list-style-type: none"> • Topical anesthetic(s) 	<ul style="list-style-type: none"> • Gloves, nonlatex (S, M, L, XL) 	Surface disinfectant
Autoclave bags, small	<ul style="list-style-type: none"> • Overgloves 	Syringe Needles (long & short)
Autoclave bags, medium	Headrest covers	Tray covers
Autoclave tape	Instrument trays, reusable	Trash bags
Barrier covers/tape	Paper towels	

APPENDIX B – Expendable Restorative Materials List Provided by Exam Site Host (Clark College) To be provided in sufficient quantities for all Restorative Candidates		
2x2 gauze squares	Drinking cups	Sanitizing materials
Air syringe tips	Face masks	Rod posts (mounting Typodont)
Amalgamator/Tricherator	Facial tissue	Soap
Amalgam scrap container(s)	Gloves, nonlatex (S, M, L, XL)	Surface disinfectant
Barrier covers/tape	Instrument trays, reusable	Tray covers
Cotton-tip applicators	Paper towels	Trash bags