



Temple College Dental Hygiene CDCA-WREB-CITA Dental Hygiene Candidate Handbook

Temple College
2600 South First St
Temple, Texas 76504
www.templejc.edu

Welcome to the Temple College Dental Hygiene School

The faculty and staff of the **Temple College Dental Hygiene Department** realize clinical boards are inherently stressful, especially when applicants are working in an unfamiliar clinic. It is our sincere hope that this handbook, which has been prepared to help assist dental hygiene candidates for the CDCA-WREB-CITA administered ADEX dental hygiene exam, will help make your time with us as smooth as possible. **If you have additional questions after reading this handbook, please contact us at (254-298-8657), or visit our website (www.templejc.edu) for more information.**

Temple College Dental Hygiene school is located in Temple, Texas on the **EAST campus** of Temple College.

FACILITY FEE

The facility fee is \$175.00 and will be collected by CDCA-WREB-CITA during online candidate registration.

TRAVEL and HOUSING ARRANGEMENTS

1. Airline and Airport Information –

- **Austin-Bergstrom International (AUS)** approximately 1 hour south of Temple
Killeen-Fort Hood Regional Airport approximately 45 minute drive to Temple

2. Chauffeured Ground transportation

Transportation via van, limousine, or bus is available from the airport.

Rental Car Information – check with the airport you are flying into to verify availability.

Rental Cars

Alamo
Avis
Dollar
National
Enterprise

3. Driving Instructions

We are located in central Texas off of IH 35. If coming from the north or south you will exit IH 35 at Exit 299 and head east on TX-36/TX-363 Loop E/US Hwy 190E. At stop light, turn left onto South 1st St./Veterans Memorial Dr. Turn right onto Marvin Felder Drive which will bring you to the EAST Campus of Temple College. Park in the first large lot on your right as you turn onto Marvin Felder Drive. There is a sidewalk from the parking lot that will bring you to the Health Science Center building and the Dental Hygiene Clinic.

If you use **GOOGLE Maps- you can use the following address: 2511 South First St.** Temple Texas 76504. **DO NOT USE iPhone MAPS** – It does not recognize either address – it will bring you to the main campus only.

Map of campus follows.

4. Hotel/Motel Accommodations

Reservations should be made directly with hotels/motels accommodations located close to the school are listed below. Candidates should call for rates.

- Hilton Garden Inn Temple Medical Center
- Holiday Inn Express & Suites Temple Medical Center
- Home2 Suites by Hilton Temple
- Candlewood Suites Temple Medical Center

5. Gas/Food and ATM's

There is a micro-market located in the HSC bldg. with light food and drinks to purchase with a credit card.

6. Security

Temple College does have an on-campus police department for the dates of the examination. Situations requiring security or police presence should be referred to local law enforcement authorities 911 or the college police department @ 8911.

Temple College Facility and Services

1. Building and Access Hours:

The Temple College Health Sciences building will open from 6:00 a.m. to 6:00 p.m. on examination day, unless otherwise requested by the CDCA-WREB-CITA.

2. Food and Beverage Services:

There is a micro-market located in the HSC bldg. with light food and drinks to purchase with a credit card.

There are several gas stations, restaurants and fast-food establishments located within one (1) mile of the campus if you wish to purchase food. However, food or drink are not allowed in any areas near the candidate clinics or check in desk during the examination.

3. Registration and Identification Badges

Numbered badges issued to candidates (by CDCA-WREB-CITA at the exam) will serve as your I.D. throughout the examination. The badge must be worn at all times while in the building. Badges must be turned in at the completion of the examination(s) as a part of the checkout procedure with CDCA-WREB-CITA.

4. Parking

There are 2 lots available as noted on the map. Candidates may park in student parking lots: **EAST CAMPUS PARKING** or in **THE PAV Open Parking** on the East Campus. Do not park in the Faculty/Visitor parking lot. A campus/parking map has been included in this candidate guide for your convenience.

Preparing for the Clinical Phase of the Examination

Candidates will be using the Temple College dental hygiene clinic. Each candidate will be assigned a numbered operator that corresponds to his or her numbered I.D. badge issued prior to the start of the exam. Each operator is equipped with one dental chair, one delivery unit equipped with air/water syringe, and one operator's stool. All equipment malfunctions that take place during the examination should be immediately reported to the Chief Examiner.

Emergency Equipment and Preparedness for Medical Emergency

All candidates should familiarize themselves with the location of the oxygen/emergency cart (medical emergency kit) and the first aid kit. During the examination, the emergency cart/first aid kit and the AED are located in the dental hygiene clinic next to the sterilization room. **In the event of an emergency, the procedure is:**

- a. STAY WITH YOUR PATIENT; verbally notify the CDCA-WREB-CITA Floor Assistant, School Coordinator or Chief Examiner of the emergency.
- b. Make sure someone calls the local 9-1-1 (notify EMS).
- c. Administer oxygen (O₂) from the green oxygen cylinder located next to the medical emergency kit.
- d. Administer Basic Life Support (BLS) until EMS arrive.

During the Board

1. Sonic/Ultrasonic Devices.

All operatories are equipped to operate the ultrasonic devices listed/pictured below. The air pressure to each operator chair and all the handpieces are factory set at approximately 35 to 50 psi. Please ensure that your devices will operate effectively within these parameters. If you bring your own ultrasonic scaling unit please familiarize yourself with the dental chairs and hook-up/connection features outlined in this section of the guide. Please note the single water hook-up/connection picture below for all ultrasonic scaling units. The water hook-up is a standard ADEC hook up (please see the picture below of the 8.0 Water Tubing with ¼ male non-shut off quick release attachment or visit www.autoscaler.com for manufacturers unit specifications and limitations).



- Temple College features magnetostrictive ultrasonic scaling units that use 30K inserts. The handpiece accepts Dentsply® Cavitron® Brand/Type 30K TFI, P, SLI, and FSI ultrasonic inserts. If you are still in doubt about what types of tips to obtain Temple College commonly uses the Cavitron THINsert 30K CTI-10S (Reorder 81551), the SlimLINE 30K FSI-SLI-10S (Reorder 80395), and the PowerLINE 30K FSI-PWR-1000 (Reorder 80799). **Note: All Ultrasonic Scalers available for candidate use provided for free by Temple College utilize magnetostrictive technology.** Please familiarize yourself with the application, limitations, and restrictions of this technology before you arrive to the examination site.
- All ultrasonic units supplied for candidates by Temple College are provided “as is” and are in a “used” condition. Every effort has been made to ensure that rentals are in good working order; however, due to their “used” condition performance expectations may vary from unit to unit. **All tips/inserts for all available ultrasonic units (along with gaskets for tips/inserts) are not supplied by Temple College and are not available for rental or purchase from Temple College. Please plan accordingly and bring your own ultrasonic tips with gaskets!**

3. Infection Control/Asepsis Requirements

a. Surface Asepsis

- Handles of the unit light, radiographic tube heads, and chair head and chair controls must be covered with either clear plastic barrier wrap or aluminum foil.
- The patient chair, dental unit, counter tops, and operator stool should be disinfected with disinfectant wipes.
- Disinfectant wipes, plastic/barrier headrest covers and plastic/barrier wrap are provided by Temple College for all candidates free of charge.
- Disposable plastic overgloves are available (free of charge) for candidates upon request.
 - Candidates must furnish their own sturdy utility gloves (nitrile preferred) to be worn when handling or packaging dirty instruments through (or to and from) the candidate clinic area.
 - Universal infection control guidelines and Personal Protective Equipment (P.P.E.) and guidelines should be observed during the CDCA-WREB-CITA

exam at Temple College. This includes standard OSHA standards and guidelines.

b. Personnel Protective Equipment

- i. Appropriate protective equipment (which includes disposable gowns) is provided/available by Temple College (one per day free of charge) and must be worn in all occupational exposure situations.
- ii. Disposable gloves, masks, and gowns will be available on the clinic floor free of charge during the examinations.
- iii. Candidates must provide their own OSHA-acceptable protective glasses. Please note that Temple College does not provide disposable side shields for glasses.

Temple College ASSUMES NO RESPONSIBILITY OR LIABILITY FOR CANDIDATES WHO BRING DENTAL/DENTAL HYGIENE INSTRUMENTS, ULTRASONIC SCALERS, OR OTHER PERSONAL EFFECTS/ITEMS ONTO CAMPUS. THIS POLICY ALSO INCLUDES ITEMS THAT MAY BE LOST, BROKEN, STOLEN, OR DAMAGED.

4. Disposable Items:

All of the following items are expendable materials and are provided free of charge by Temple College to all candidates.

- | | | |
|------------------------------|------------------------------------|----------------------------|
| ● Surface disinfection wipes | ● Non-latex gloves (S-XL) | ● Sanitizing materials |
| ● Barrier materials & tape | ● Air water syringe tips (plastic) | ● Paper towels |
| ● Bracket tray covers | ● Facial tissue | ● HVE Tips |
| ● Patient napkins | ● Headrest covers | ● Standard saliva ejectors |
| ● Barrier tape (roll) | ● Face masks | ● Autoclave bags (S-L) |
| ● Tray covers/Barriers | ● Cotton rolls | ● 2 x 2 gauze squares |
| ● Soap (liquid) | ● Disposable bib clips | ● Over gloves |

Disposable Air/Water Syringe Tips and Bite Blocks

Temple College provides and uses disposable air/water syringe tips for the examination. Candidates should plan ahead and bring bite blocks to make their patients more comfortable during the exam. If you prefer metal air/water syringe tips you should plan accordingly and bring them to the exam with you as Temple College does not provide them.

5. Translation Services

Translation services for candidates and patients are not provided by Temple College. Candidates wishing to bring a translator (for languages other than English) must provide all

accommodations required. All translators must check in with the CDCA-WREB-CITA desk coordinator and school coordinator upon arrival and will only be allowed into the clinical area when their services are required. Candidate translators must abide by all applicable candidate rules (no cell phones, notes, or PDA's) and safety requirements as well as all reasonable CDCA-WREB-CITA and/or Temple College school coordinator requests to ensure that all other candidates have a fair, secure, quiet, safe, effective, and successful examination.

6. Other Limitations

No instrument sharpening services for dental hygiene instruments are available at Temple College before, during, or after the examination(s). If a candidate experiences a broken tip on one or more of their instruments during the examination Temple College does NOT have replacement instruments to loan/sell to candidates, so please come prepared accordingly. Items left behind after a candidate's exam is completed may not be returned. Temple College will make every effort to remind candidates not to leave instruments and other items behind when they leave as Temple College will not mail ANY items left behind. If candidates request any help from the Temple College School Coordinator or staff, we will be happy to help, however the candidate assumes all responsibility for any help or attempted assistance given. Inadvertent damage or perceived damage to any personal items, instruments, ultrasonics, or other items that the candidate is seeking help with is the sole responsibility of the candidate. Temple College does not rent ultrasonics or ultrasonic tips.

EXAM ROOM ASSIGNMENTS

***(NOTE: See official CDCA-WREB-CITA documents for days, dates, and times
See Temple College Dental Hygiene Clinic Floor Plan on following page for Locations)***

We hope that this guide has been helpful and that your examination experience at Temple College will be a pleasant one. Good luck on your examination!

Temple College Dental Hygiene Clinic Floor Plan

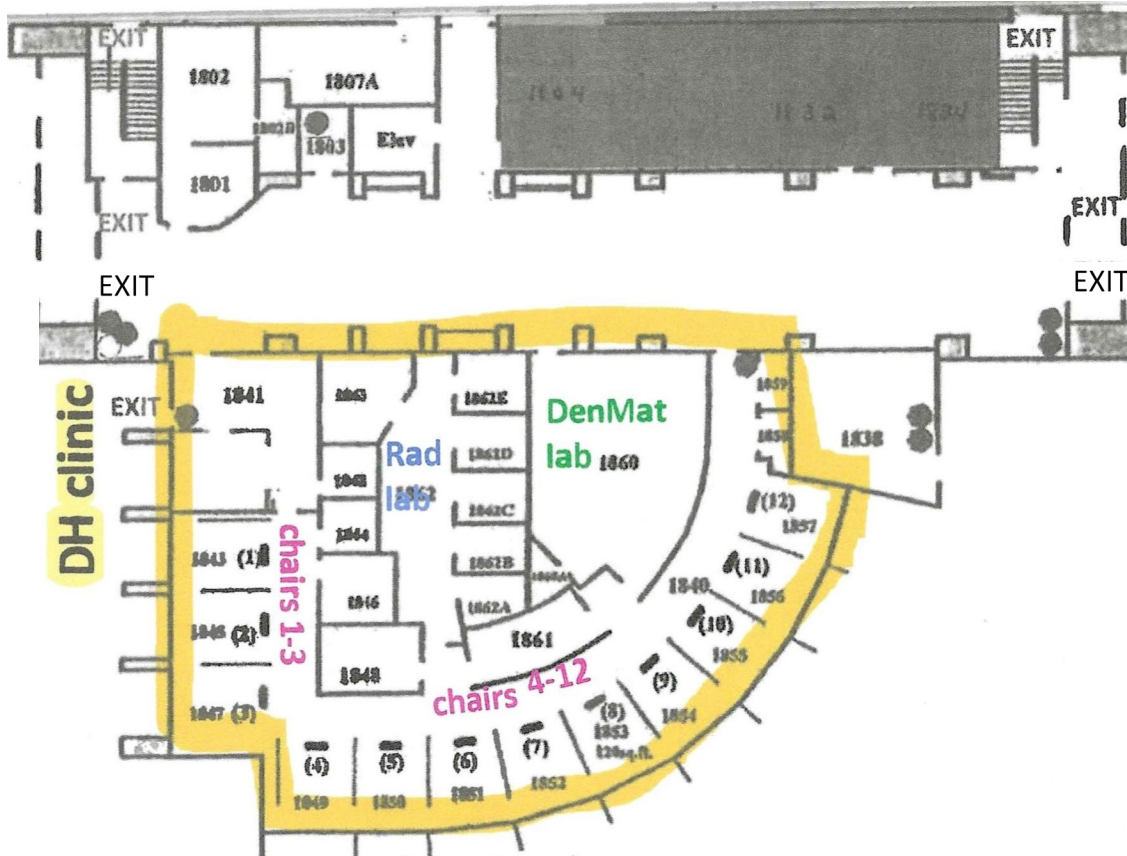

Health Science Center 1st Floor

Temple College Campus Map

