

UNIVERSITY OF THE PACIFIC  
Arthur A. Dugoni School of Dentistry

**University of the Pacific School of Dentistry  
CDCA-WREB-CITA Dental Candidate  
Handbook**

## **Welcome to the University of the Pacific School of Dentistry**

The faculty and staff of the University of the Pacific School of Dentistry realize clinical boards are inherently stressful, especially when applicants are working in an unfamiliar clinic. It is our sincere hope that this handbook, which has been prepared to help assist dental candidates for the CDCA-WREB-CITA-administered ADEX dental licensure exam, will help make your time with us as smooth as possible. **If you have additional questions after reading this handbook, please contact a manager at [jmcglothlin@pacific.edu](mailto:jmcglothlin@pacific.edu), or visit our website [www.dental.pacific.edu](http://www.dental.pacific.edu) for more information.**

University of the Pacific is located at:

155 5<sup>th</sup> Street, San Francisco, CA 94103

### **1. Nearest airport: SFO (San Francisco International)**

### **2. Hotel/Motel Accommodations**

Reservations should be made directly with hotels/motels accommodations located close to the school are listed below. Candidates should call for rates. There are many other hotels in downtown San Francisco, please search for additional accommodations. **Please do not call the school for hotel information, this list is for your convenience only and we do not recommend one hotel over another.**

WESTIN	335 POWELL STREET	(415) 397-7000
MARRIOTT	480 SUTTER STREET	(415) 398-8900
HOTEL ZETTA	55 – 5 <sup>TH</sup> STREET	(415) 543-8555
INTERCONTINENTAL	888 HOWARD STREET	(415) 616-6500
HILTON	333 O'FARREL STREET	(415) 771-1400

### **3. Parking:**

There is a public parking lot located on the corner of 5<sup>th</sup> and Mission Streets, next to the University of the Pacific School of Dentistry which charges by the hour. We do not validate parking.

Street parking is limited to metered parking and the fine for overtime parking is quite expensive.

## Directions to the school:

The School of Dentistry is located at 155 5<sup>th</sup> Street. Entrance to the exam will be on 5<sup>th</sup> Street, the “Faculty/Staff/Student Entrance”. **Please do not enter through the patient entrance on 5<sup>th</sup> and Minna Street.**

## From the Airport

Take Highway 101 north to San Francisco. Take the Seventh Street exit and make a left onto 7<sup>th</sup>. Make a right on Folsom to 5<sup>th</sup> Street, then make a left on 5<sup>th</sup> St. There is a parking garage on the corner of 5<sup>th</sup> and Mission.

Google Maps University of the Pacific, Arthur A. Dugoni School of Dentistry

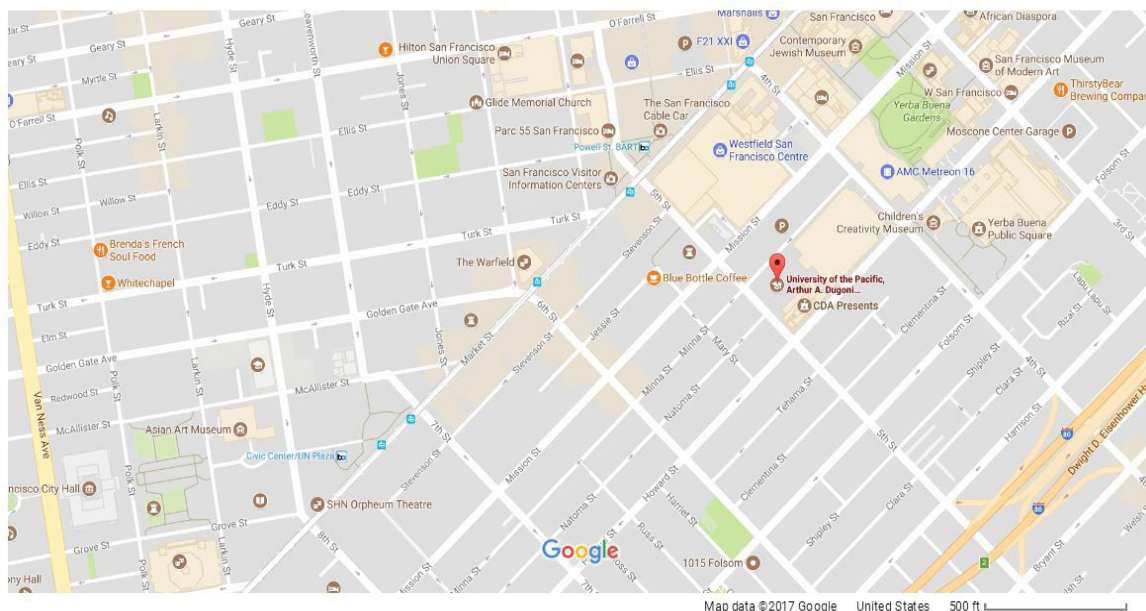

## Food/Lunch Facilities

Please be advised that we **do not** have food, beverage, or cafeteria services available to candidates during weekends. There are many outside food establishments within walking distance of the school. At the Westfield Shopping mall located at 5<sup>th</sup> and Mission there is a food court with a variety of eateries available. At the Metreon on 4<sup>th</sup> and Minna there is also a food court.

**Please remember that no food or drink are allowed in the clinical areas or operatories.**

## University of the Pacific School of Dentistry Facility and Services

### 1. Building and Access Hours:

The University of the Pacific School of Dentistry building will open from 6:00am on examination days during the exam, unless otherwise requested by CDCA-WREB-CITA. Please note that **the day before the examinations begin**, the building and campus **will be closed to everyone** (including tours) for cleaning and pre-examination set-up.

### 2. Registration and Identification Badges

Numbered badges issued to candidates (by CDCA-WREB-CITA usually at orientation) will serve as your I.D. throughout the examination. The badge must be worn at all times while in the building. Badges **must be turned in** at the completion of the examination(s) as a part of the checkout procedure with CDCA-WREB-CITA.

## Preparing for the Clinical Phase of the Examination

Candidates will be using the University of the Pacific School of Dentistry Simulation Clinic for the exam, located on the 5<sup>th</sup> floor of the school. Each candidate will be assigned a numbered operatory that corresponds to his or her numbered I.D. badge issued at orientation. Each operatory is equipped with one dental chair, one delivery unit equipped with air/water syringe, and one operator's chair. There is no need to request a left-handed user chair, as our units can be configured for both.

There will be no storage areas available for your equipment in the clinic, you will need to bring and take your equipment with you each day.

Equipment malfunctions: We will have technicians from our Building Operations team available all day if you experience any problems with your equipment.

## During the Exam

### 1. Facility Fee & Instrument Kit Rentals

The facility fee for this exam is \$760, which also includes rental of instruments, handpieces, and use of all dental materials needed for the exam.

**Even if you choose to bring your own instruments/materials, you are still responsible for the facility fee, as this covers the school's costs to administer the exam. The instrument rental included in the facility fee is offered as a courtesy to the candidates rather than charging a separate instrument rental fee.** If you have questions about equipment or materials, please contact Fayyaz Ibrahim at [fibrahim@pacific.edu](mailto:fibrahim@pacific.edu)

## 2. CDCA-WREB-CITA will provide all typodonts for the exam

## 3. Handpiece and Prophy Angle Hookups

We have Kavo and BienAir electric high speed and slow speed handpieces, as well as Star air-driven high and slow speed handpieces.

## 4. Infection Control/Asepsis Requirements

### a. Surface Asepsis

- i. The patient chair, dental unit, counter tops, and operator stool should be disinfected with disinfectant wipes provided by the school.

### b. Personal Protective Equipment (PPE)

- i. Disposable gowns, nitrile gloves, Level 3 masks, and face shields will be made available to all candidates free of charge.
- ii. Candidates must provide their own loupes or protective eyewear.

### c. Sterilization

- i. If you choose to bring your own instruments to the exam, the University of the Pacific School of Dentistry does not provide sterilization services for your instruments.

*THE UNIVERSITY OF THE PACIFIC SCHOOL OF DENTISTRY ASSUMES NO RESPONSIBILITY OR LIABILITY FOR CANDIDATES WHO BRING DENTAL INSTRUMENTS, OR OTHER PERSONAL EFFECTS/ITEMS ONTO CAMPUS. THIS POLICY ALSO INCLUDES ITEMS THAT MAY BE LOST, BROKEN, STOLEN, OR DAMAGED, (OR THAT ARE NOT RETRIEVED WITHIN FIVE DAYS AFTER THE CLOSING OF THE EXAMINATION).*

## 5. Disposable Items:

All of the following items are expendable materials and are provided free of charge by the University of the Pacific School of Dentistry to all candidates.

- |                              |                                    |                        |
|------------------------------|------------------------------------|------------------------|
| ● Surface disinfection wipes | ● Non-latex gloves (S-XL)          | ● Sanitizing materials |
| ● Barrier materials & tape   | ● Air water syringe tips (plastic) |                        |
| ● Bracket tray covers        | ● Facial tissue                    |                        |
| ● Red biohazard bags         | ● Patient napkins                  |                        |
| ● Headrest covers            | ● Standard saliva ejectors         |                        |
| ● Barrier tape (roll)        | ● Face masks                       |                        |
| ● Tray covers/Barriers       | ● Cotton rolls                     |                        |
| ● Styrofoam instrument trays | ● Soap (liquid)                    |                        |
| ● Overgloves                 | ● 2 x 2 gauze squares              |                        |
| ● HVE Tips                   | ● Paper towels                     |                        |
| ● Disposable bib clips       | ● Prophy paste                     |                        |

## 6. Other Limitations

Items left behind after a candidate's exam is completed may not be returned. University of the Pacific School of Dentistry will make every effort to remind candidates not to leave instruments and other items behind when they leave, as University of the Pacific School of Dentistry will not be able to mail any items left behind.

Inadvertent damage or perceived damage to any personal items, instruments, or other items that the candidate is seeking help with is the sole responsibility of the candidate.

## QUESTIONS?

**For any facility or dental supply questions, please contact:**

- Jennifer McGlothlin, Group Practice Manager, [jmcglothlin@pacific.edu](mailto:jmcglothlin@pacific.edu) (Facility questions)
- Fayyaz Ibrahim, Clinic Operations Manager, [fibrahim@pacific.edu](mailto:fibrahim@pacific.edu) (Supply/instrument kit questions)

**For any questions related to the exam itself, please contact CDCA-WREB-CITA/ADEX through their website: [cdcaexams.org](http://cdcaexams.org)**

**Please do not call the University of the Pacific School of Dentistry for any specific questions regarding the exam (format, grading criteria, etc.)**

***Thank you and best of luck on the exam!***

## Floor Maps

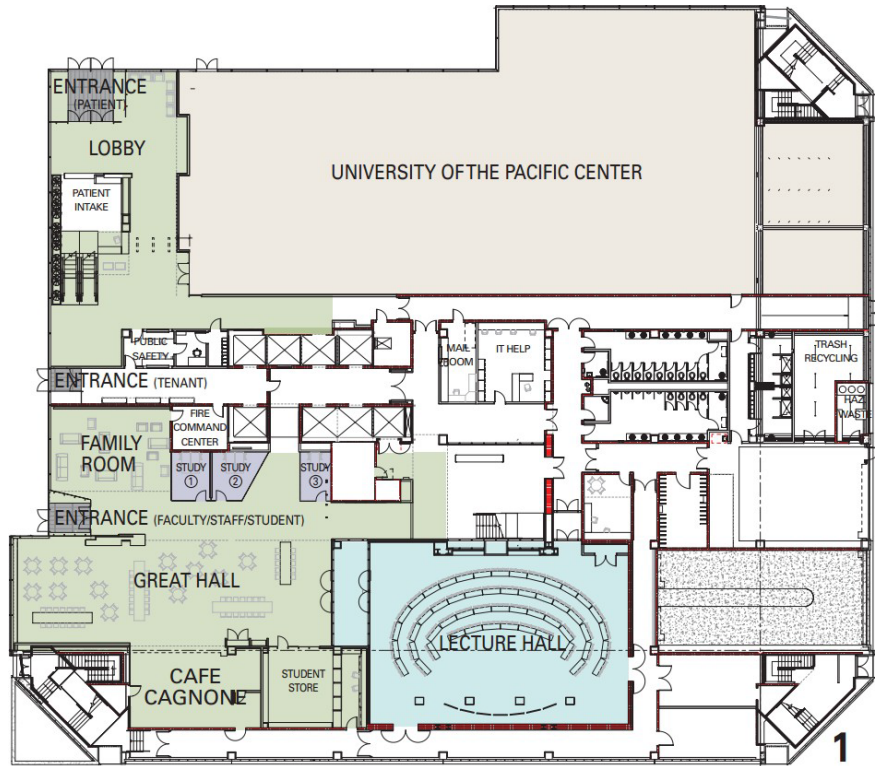

First Floor



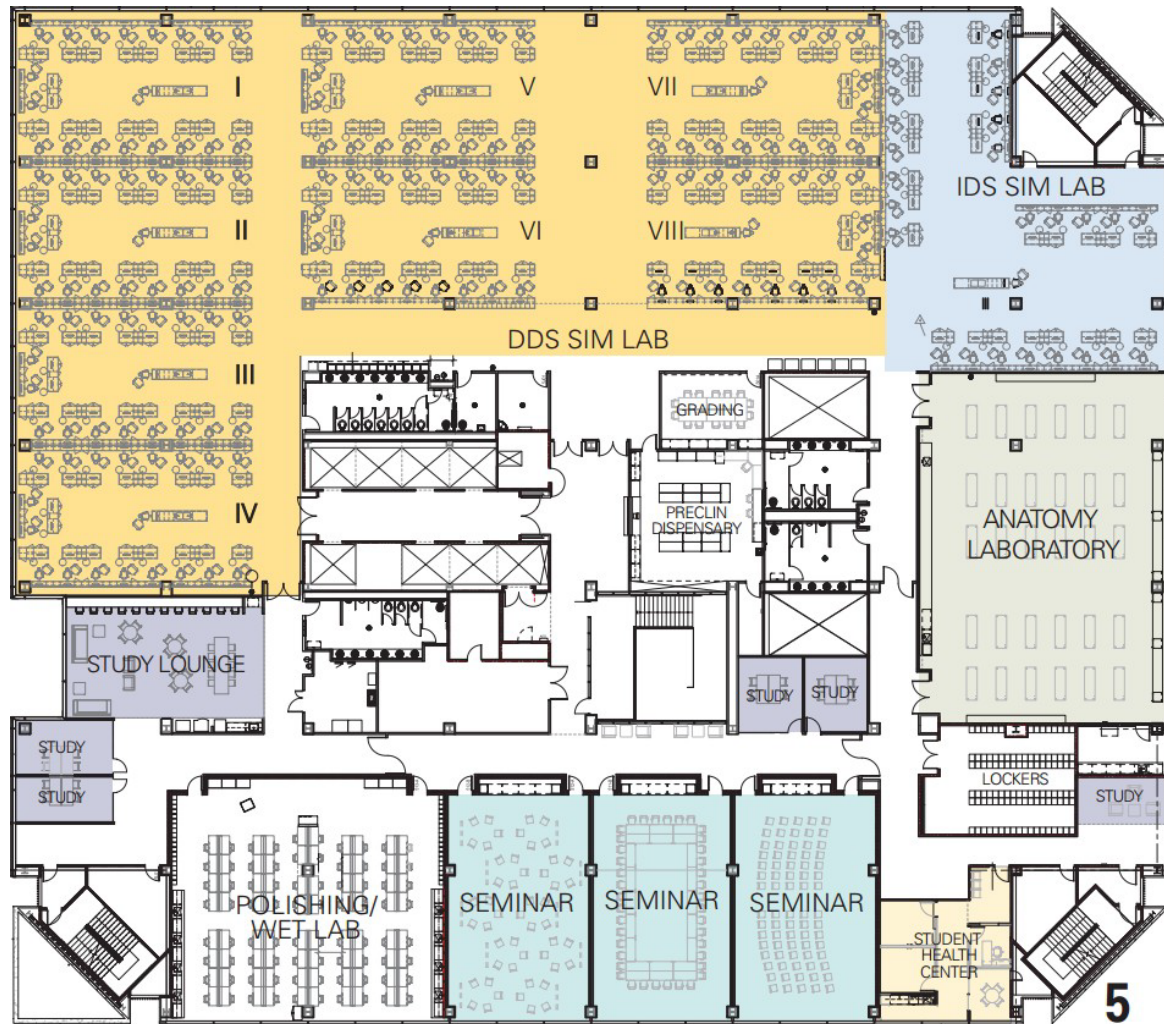

**Fifth Floor**