



**Exam Site Information for Candidates
CDCA-WREB-CITA
2023 Dental Hygiene Clinical Examination**

**Santa Rosa Junior College
Dental Hygiene Clinic
Race Building, Room 4033
1501 Mendocino Ave
Santa Rosa, CA 95401
707-522-4934**

**Exam Site Information
2023 Dental Hygiene Clinical Examination
Table of Contents**

1. School Facility and Services

- Facility Fees
- General information
- Clinic Address, Building Access and Hours
- Parking
- Security and Emergency Services
- ATM Machine
- Food Services

2. Preparing for the Exam

- Dental Operatory Units
- Equipment, Instruments and Expendable Materials

3. During the Exam

- Infection Control (Surface Asepsis)
- Medical Emergencies and Equipment

4. Travel and Lodging Information

- Airport Information
- Ground Transportation
- Hotel Accommodations

5. Campus Map

6. Clinic Floor Plan

1. School Location and Services

General Information

- **Facility Fees**
 - The facility fee is \$325.00 and will be collected by CDCA-WREB-CITA at time of online registration.
 -
- **Location, Building Access and Hours:** The Dental Hygiene Clinic is located in the Race Building, Room 4033. The main campus address is 1501 Mendocino Ave, Santa Rosa, CA 95401. The most convenient parking lot adjacent to the clinic is Emeritus Circle Parking. Look for the Purple Dental Clinic Flag. The main entrance of the Race Building is located on the south side of the building, under the large white balcony.
 - **Please contact Jennifer Apocotos-Kirk at 707-527-4934 for questions regarding the school, equipment, etc.**
- Santa Rosa Junior College is a smoke-free campus.
- **Parking:** A SRJC parking permit is required for vehicles parked on college property. Daily parking permit is available for \$4.00. Look for the gray parking kiosks located in every parking lot. Enforced, one hour metered parking is also available for \$1.00 per hour. If a parking kiosk is not working, report machine number and location to District Police at 707-527-1000; then proceed to the closest working kiosk machine to pay the parking fee. Parking rules are strictly enforced on campus. Do not park in fire lanes or in any space without a permit. Handicapped spaces are available. Appropriate handicap placards are required to park in these spaces. Please do not park in any spaces marked in “E” lot, these are designated for faculty only.
- **Security and Emergency Services:** The Santa Rosa Junior College Police department is the District Police Department of the Santa Rosa Junior College, and is located in the Pedroncelli Center, on the north corner of Elliott Avenue and Armory Drive.

For emergency assistance, call 1000 from campus phones. From cell phones, call 707-527-1000. Non-emergency situations (to report non-violent crimes, non-injury vehicle accidents, or for assistance), please call 707-527-1000 or

dial extension 1000 from campus phones. The campus police department is closed on Sundays.

To contact District Police through the use of a TTY device or a TTY enabled iPhone please use the TTY Line at **(707) 527-4230**

This line uses ipTTY software to communicate with TTY enabled devices using real time text.

- **ATM Machine:** Currently there are no ATM's available on campus. The closest ATM is at Safeway in the Mendocino Marketplace 2300 Mendocino Ave, Santa Rosa, CA 95403, ½ mile from SRJC campus
- **Food Services Onsite:** During the exam, Santa Rosa Junior College will not have food, beverages, or cafeteria services for candidates. On site refrigeration will not be provided.

Restaurant	Address and Phone Number	Miles from SRJC Campus
Goji Kitchen Asian Fusion	1965 Mendocino Ave, Santa Rosa, CA 95404 (707)-523-3888	0.3 miles from SRJC Campus
Ike's Love and Sandwiches	1780 Mendocino Ave, Santa Rosa, CA 95404 (707)-293-9814	0.3 miles from SRJC Campus
Taqueria Santa Rosa	1950 Mendocino Ave, Santa Rosa, CA 95401 (707)-528-7956	0.4 miles from SRJC Campus
Cozy Plumb Plant-Based Food	1899 Mendocino Ave. Santa Rosa, CA 95401 (707) 526-3333	0.3 miles from SRJC Campus

2. Preparing for the Hygiene Exam

- **Equipment, Instruments and Expendable Dental Materials:** Please refer to the current Dental Hygiene Candidate Guide for a list of materials and armamentarium that the Candidate must provide.

A. Sonic/Ultrasonic Devices: Candidates must use their own Cavitron Ultrasonic Scaler and inserts. **No Cavitron units or inserts will be**

- available to rent.** Connections are housed on the side of the dental chair with a universal water connection.
- B. Air/Water Syringe Tips:** disposable air/water syringe tips will be available during the exam.
- C. Expendable Materials:** Expendable dental materials supplied by the school. Items not listed are the responsibility of the Candidate.

Expendable Dental Hygiene Materials provided by Exam Site Host (School)	
2x2 gauze squares	Instrument trays, disposable
Air/water syringe tips	Paper towels
Barrier covers/tape	Rod posts (mounting Typodont)
Drinking Cups	Sanitizing materials
Face masks	Soap
Facial tissue	Standard saliva ejectors
Gloves, nonlatex (S,M,L,XL)	Surface disinfectant
Hand towels	Tray covers
High volume evacuation tips	Trash bags

3. During the Clinical Exam

- **Dental Operatories:** The dental operatories in the clinic are equipped with ADEC chairs with standard connections. Eighteen operatories will be available for the dental hygiene exam. All units are ambidextrous and can be set up for either right-or left-handed operators. Units 1 and 18 are wheelchair accessible.
- **Infection Control (Surface Asepsis):** Personal Protective Equipment (PPE) requires the use of gloves, mask, protective eyewear and clinic gowns while providing direct patient care. A face shield is required while in the SRJC clinic at all times. Santa Rosa Junior College does not provide protective eyewear, face shields, lab coats or gowns for candidates or protective eyewear for patients.
- **Computers and keyboards:** The computers and keyboards in clinic are not to be used by candidates.
- **Emergency Medical Equipment:** Three fire extinguishers are located in Dental Area the restorative clinic 5300 building by the door to the radiology lab, the door in 5301 and in the hallway next to the clinic staff office. Eyewash stations are located at the sinks in the sterilization area at the back

of the clinic and the radiology lab. To use: remove the yellow caps, pull the metal stopper on the back of the faucet and turn on the water. Flush eyes thoroughly. The portable emergency oxygen tank is located at East end of clinic adjacent to unit 1 in the clinic. The AED is located on the east wall adjacent to unit 1. The first aid kit and emergency drug kit can be found at the east end of clinic adjacent to unit 1 in the cabinet marked with a red cross. A blood pressure cuff and stethoscope are also located in this drawer. Ice packs are available please ask office staff. The clinic manual which outlines emergency procedures and puncture protocols is located on the shelf above the copier. A fire station is located just minutes from the clinic. In case of an emergency, please exit the clinic through the west clinic door and proceed to the Emeritus Circle Parking Lot. **For emergency assistance, dial 1000 from any campus phone.**

4. Travel and Lodging Information

- **Airport Information:** Santa Rosa Junior College is located in Santa Rosa, California and is 6.1 miles from the Charles M. Schulz-Sonoma County Airport, 61 miles from San Francisco International Airport and 58 miles from Oakland International Airport.
- **Ground Transportation:** Santa Rosa Transit and City Bus has one bus line that includes Santa Rosa Junior College, Route 1-Mendocino Avenue. Please see <https://srcity.org/1036/Transit-and-CityBus> for more detailed information
- **Hotel Accommodations:** Several hotels/motels are located a few miles from the college.

Hotel	Address and Phone Number	Miles from SRJS Campus
The Sandman Hotel	3421 Cleveland Ave, Santa Rosa, CA 95403(707 293-2100)	1.3 miles from the College
Hotel La Rose	308 Wilson St, Santa Rosa, CA 95401•(707) 579-3200	1.4 miles from the College
La Quinta Inn & Suites by Wyndham Santa Rosa Sonoma	111 Commercial Ct, Santa Rosa, CA 95407•(707) 596-9800	3.2 miles from College
AC Hotel by Marriott Santa Rosa Downtown	300 Davis St, Santa Rosa, CA 95401•(707) 527-1075	1.6 miles from the College

Santa Rosa Junior College Campus Map- The Dental Hygiene Clinic, Race Building, Room 4033, 1501 Mendocino Ave, Santa Rosa, CA 95401

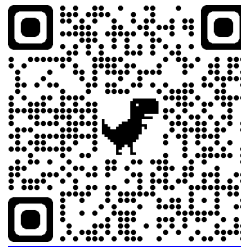

- Santa Rosa Junior College Campus Parking Map-** The Dental Hygiene Clinic, Race Building, Room 4033, 1501 Mendocino Ave, Santa Rosa, CA 95401. Follow signs to the clinic from the parking lot. Handicap parking is located Emeritus Circle.

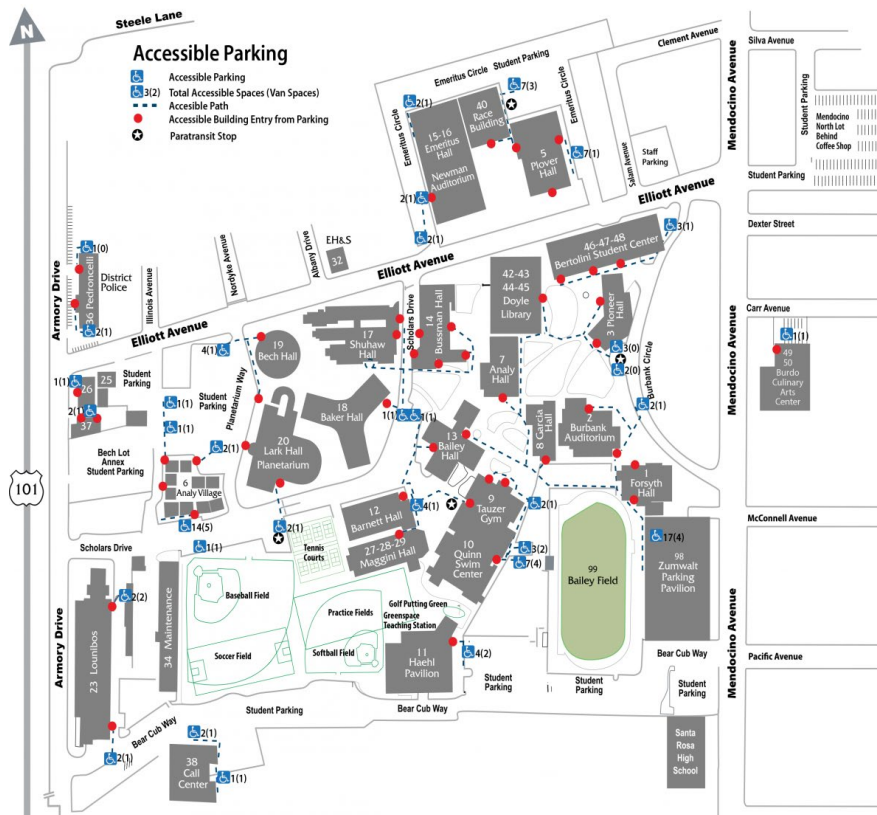

- **Clinic Floor Plan-** Indicate Patient waiting area, Candidate clinic, Examiner grading area, areas of emergency equipment

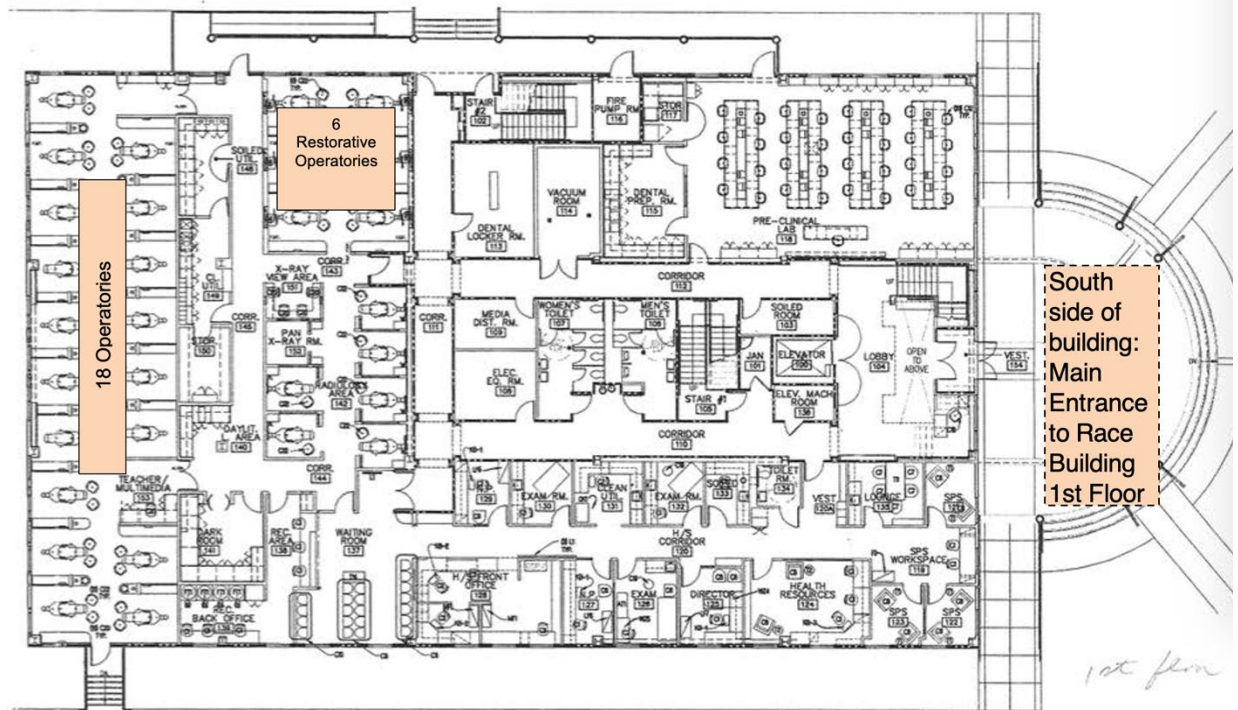

Clinical Pictures:











