



**Exam Site Information for Candidates
CDCA-WREB-CITA
2023 Dental Hygiene Examination**

**Lake Washington Institute of Technology
11605 132nd Avenue NE
Kirkland, WA 98034
425-739-8157**

1. School Facility and Services

- **Facility Fees**

The facility fee is \$165.00 and will be collected by CDCA-WREB-CITA at time of online registration.

- **Location, Building Access and Hours:**

Lake Washington Institute of Technology
11605 132nd Avenue NE, E106, Kirkland WA 98034

Carrie Sasynuik: carrie.sasynuik@lwtech.edu (preferred) or (425) 739-8157

Building Opens: 6:00am-6:00pm daily for duration of exam.

- **Parking:** Any open parking area; no charge for parking.
- **Security and Emergency Services:** 425-739-8224 or 911

2. Preparing for the Clinical Phase of the Examination

Candidates will be using the Lake Washington Institute of Technology dental hygiene clinic. Each candidate will be assigned a numbered operatory that corresponds to his or her numbered I.D. badge issued prior to the start of the exam. Each operatory is equipped with one dental chair, one delivery unit equipped with air/water syringe, and one operator's stool. All equipment malfunctions that take place during the examination should be immediately reported to the Chief Examiner.

All candidates should familiarize themselves with the location of the oxygen/emergency cart (medical emergency kit) and the first aid kit. **In the event of an emergency, the procedure is:**

- STAY WITH YOUR PATIENT; verbally notify the CDCA-WREB-CITA Floor Assistant, School Coordinator or Chief Examiner of the emergency.
 - Make sure someone calls the local 9-1-1 (notify EMS).
 - Administer oxygen (O₂) from the green oxygen cylinder located next to the medical emergency kit.
 - Administer Basic Life Support (BLS) until EMS arrive.
 - **Emergency Medical Equipment:**
 - A. Phones:**
 - Room 106(clinic): by the computer in the middle island
 - Front desk: out through the doors into the reception area.
 - **For emergency help dial 9-911 and then #8224** (school security).
 - B. Fire Extinguishers:**
 - Room 109: in the hall outside the Examiner's clinic
 - Room 106 by the windows and emergency exit
 - How to use: pull the pin, aim at the base of the fire, squeeze the trigger
- Do not use if faced with a large or rapidly growing fire, just exit as soon as possible (always take your patient)**

C. Nearest Exits:

- Room 106 clinic: out the emergency exit in the main dental clinic between the treatment rooms C5 and D5
- Once outside continue along the path and move away from the building

D. Eyewash Stations (wear your protective eyewear):

- Room 109: back lab
- Examiner's Clinic: 1st sink on the right
- Room 106 main testing clinic: each row of treatment rooms has one sink with an eye-wash station, be sure to locate the one that is closest to you before you begin your procedure. There is also an eye wash station in the sterilization room.

Pull off the green caps, pull the metal stopper on the back of the faucet and turn the water on. Flush eyes thoroughly.

E. Emergency Oxygen:

- Examiner's Clinic: inside door as you enter from the lab
- Room 106, main testing clinic: by the emergency exit and by the entrance door to the processing rooms.

On/Off knob is on the side (a lever), flow knob is circular, everything else is hooked up. Addition oxygen can also be found when the N2O is set up.

F. First Aid, Emergency Kits and Defibrillator (AED):

- Examiner's room #107 in the cabinets attached to the sterilization area – first aid only
- Room 106 main testing clinic: First Aid hanging on the wall by the master switch and first aid and all emergency items in four (4) drawers across from the as you enter through the main Clinic doors.
- Defibrillator (AED) mounted on the wall next to the entrance for the x-ray processing room.

MSDS Manual/Book: in op number F-1 in the cabinet

Exposures and Exposure Personnel (wear your PPE and handle sharps carefully):

Clinic Floor Coordinator – 1st office on the left as you enter clinic floor

Clinic Office Manager – Reception

3. During the Board

- **Dental Operatory Units:** ADEC/Cascade dental chair with foot control chair operations.
- **Equipment, Instruments and Expendable Dental Materials**

A. Handpiece and Prophy Angle Hookups: Handpiece hook-ups are two and four-pin

B. Air/Water Syringe Tips: Air/water syringe tips are provided by the school.

C. Blood Pressure Cuffs and Stethoscopes: The Candidate is responsible for providing their own.

D. Expendable Materials: Expendable dental materials supplied by the school free of charge (items not listed are responsibility of Candidate).

- Surface disinfection wipes
- Barrier materials & tape
- Bracket tray covers
- Red biohazard bags
- Headrest covers
- Barrier tape (roll)
- Tray covers/Barriers
- Styrofoam instrument trays
- Overgloves
- 30 gauge short needles
- HVE Tips
- Disposable bib clips
- Non-latex gloves (S-XL)
- Air water syringe tips (plastic)
- Facial tissue
- Patient napkins
- Standard saliva ejectors
- Face masks
- Cotton rolls
- Soap (liquid)
- 2 x 2 gauze squares
- 27 gauge long needles
- Paper towels
- Prophy paste
- Sanitizing materials
- Oral pre-rinse & cups
- Disposable needle stick protectors
- Cotton swab (tip applicator)
- Antimicrobial mouthwash
- Autoclave bags (S-L)
- Drinking cups (small)
- Topical anesthetic(s)
- Local Anesthetics*

- **Sterilization Services:** If you would like your instruments sterilized upon completion of your exam, place your bagged instruments, with your candidate number on the bag in the sterilization window marked contaminated. Note, we will not ultrasonic or remove your items from their labeled bags prior to sterilization. Please allow 24 hours for sterilization.

Additional supplies/handpieces might be available upon request, by contacting the school coordinator prior to the exam, by e-mail carrie.sasynuik@lwtech.edu .

- 4. Infection Control (Surface Asepsis):** Surface areas not covered by a barrier will be wiped with Biorex and a 4 x 4 gauze. These items are located at each sink station in the clinic.

Hazardous Waste Disposal:

- Any blood/saliva soaked waste is considered hazardous and should be disposed of in the available/provided (red) biohazard bags.
- Sharps: All needles, anesthetic cartridges, and any potential sharps are to be placed in the red plastic sharps containers located throughout the clinic.

5. Travel and Lodging Information

Airport Information: SeaTac (Seattle Tacoma) International-travel time approximately 45 minutes from the airport-normal traffic

Ground Transportation: Shuttle Express, rental cars

Hotel Accommodations:

The Clarion Inn at Totem Lake

12233 Totem Lake Way

425-821-2202

Silver Cloud Inn

12202 NE 124th

425-821-8300

Best Western Kirkland Inn

12223 NE 116th

425-822-2300 or 1-800-528-1234 (reservations center)

EXAM ROOM ASSIGNMENTS

See official CDCA-WREB-CITA documents for days, dates, and times. Floor Plan is on following page for Location.

We hope that this guide has been helpful and that your examination experience Lake Washington Institute of Technology will be a pleasant one. Good luck on your examination!

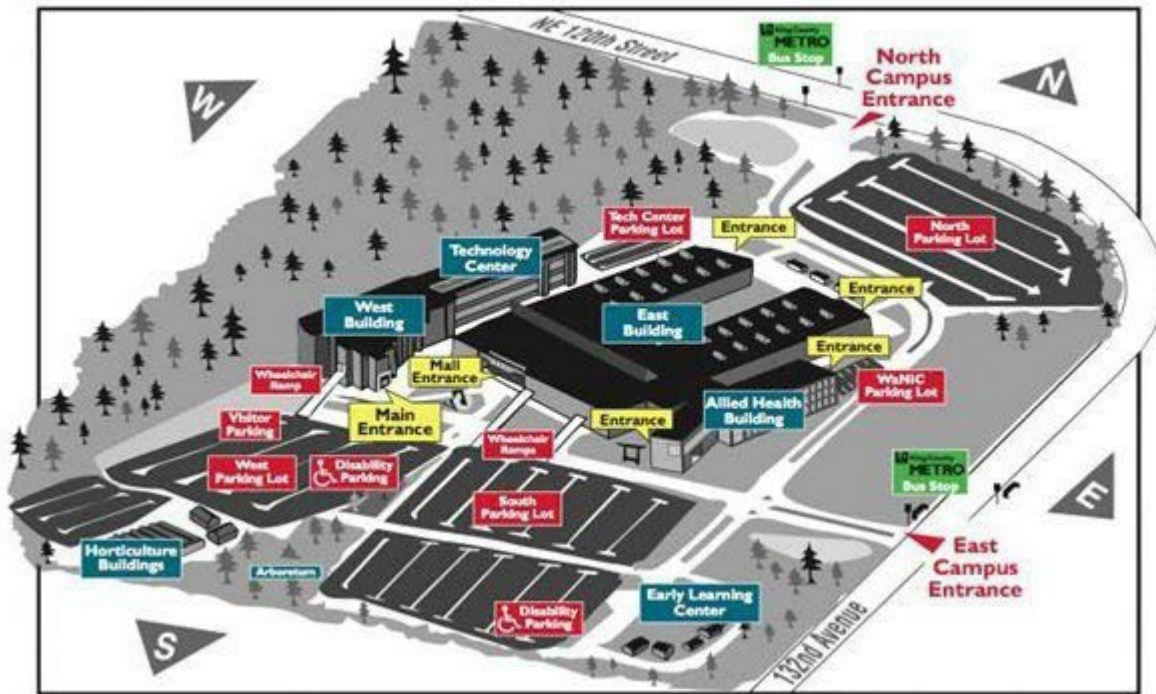

6. Campus Map:

The dental clinic located in the east building in E106. The east building is the two-story U-shaped building on the map. The dental clinic located in the lower right side of the U shape.

EAST (MAIN) ENTRANCE:

From the **South** parking lot enter through the Allied Health Building. Enter the Allied Health Building and take the elevator down to the first floor. Take a right out of the elevator, then an immediate right. Once you pass the stairs, the dental clinic entrance is through the double doors on your left. Please wait outside the double doors

NORTH ENTRANCE:

From the **North** Parking Lot enter through the East entrance of the U-shaped building. Walk down the long hallway. The last set of double doors is the entrance to the clinic. Please wait outside that entrance's double doors.



White building, east building from the South Parking Lot view. Allied Health Building entrance is off to the right of this photo.

7. **Clinic Floor Plan:** Patient waiting area-Lobby of the dental clinic, Candidate clinic-E106, 28 opswith 5 x-ray rooms, Examiner grading area-E107 and E109, areas of emergency equipment

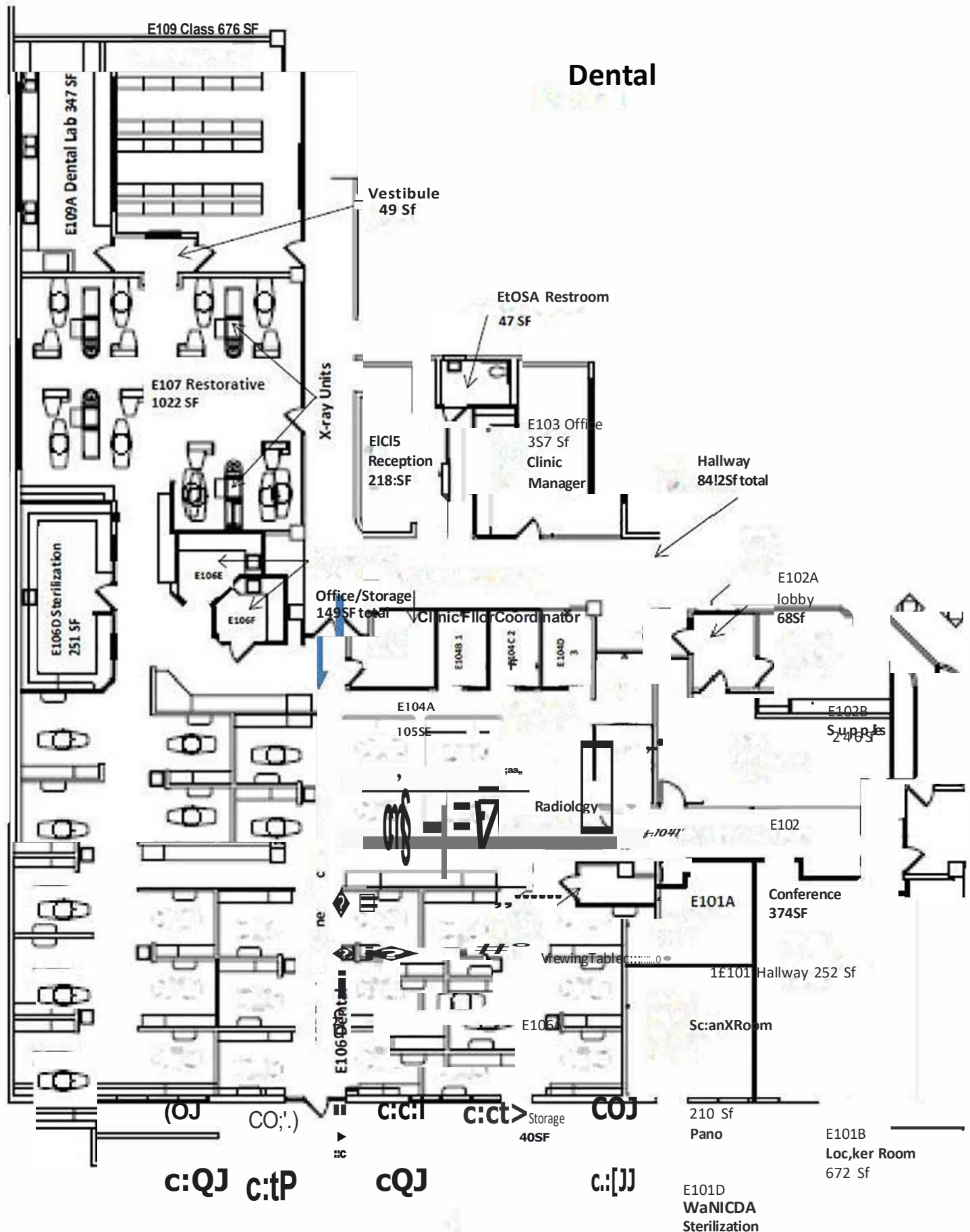

LWTech Dental
Hygiene Clinic Floor
Operator numbers

